



KING COUNTY

1200 King County Courthouse
516 Third Avenue
Seattle, WA 98104

Signature Report

December 9, 2003

Ordinance 14810

Proposed No. 2003-0429.1

Sponsors Lambert

1 AN ORDINANCE relating to the annexation of an area
2 known as Trilogy to Woodinville Water District for the
3 purpose of providing water service.
4
5

6 **STATEMENT OF FACTS:**

- 7 1. A notice of intention proposing the annexation of an area known as
8 Trilogy for water service was filed with the county council on September
9 12, 2003.
- 10 2. Woodinville Water District has found the petition for annexation to be
11 sufficient and has concurred with the proposed annexation in Resolution
12 No. 3355.
- 13 3. Woodinville Water District issued a determination of nonsignificance
14 on the proposed annexation dated July 1, 2003.
- 15 4. The utilities technical review committee recommended county council
16 approval of the proposed annexation.

17 5. The county council held a public hearing as required by law and has
18 considered the criteria in RCW 57.02.040(3).

19 BE IT ORDAINED BY THE COUNCIL OF KING COUNTY:

20 SECTION 1. Findings. The county council finds that:

21 A. The proposed action is in compliance with the county's Comprehensive Plan;

22 B. The proposed action is in compliance with the policies expressed in the
23 district's plan for water or sewage facilities, or both.

24 SECTION 2. After consideration of the criteria listed in RCW 57.02.040(3), the
25 annexation by Woodinville Water District of the area known as Trilogy and described in
26 Attachment A to this ordinance is consistent with those criteria and is approved.

27 Pursuant to RCW 57.02.045, this approval is final unless review is taken by the King
28 County boundary review board under chapter 36.93 RCW.

29 SECTION 3. Woodinville Water District is the appropriate entity to serve the
30 area proposed to be annexed.

31 SECTION 4. Completion of this annexation does not constitute county approval
32 or disapproval of any other permits, certifications or actions necessary to provide service
33 to this annexation area.
34

Ordinance 14810 was introduced on 9/29/2003 and passed by the Metropolitan King
County Council on 12/8/2003, by the following vote:

Yes: 11 - Ms. Sullivan, Ms. Edmonds, Mr. von Reichbauer, Ms. Lambert, Mr.
Phillips, Mr. Pelz, Mr. Hammond, Mr. Gossett, Ms. Hague, Ms. Patterson and
Mr. Constantine

No: 0

Excused: 2 - Mr. McKenna and Mr. Irons

KING COUNTY COUNCIL
KING COUNTY, WASHINGTON

Cynthia Sullivan, Chair

ATTEST:

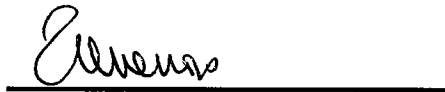

Anne Noris, Clerk of the Council

RECEIVED
2003 DEC 18 PM 4:19
CLERK
KING COUNTY COUNCIL

APPROVED this 18 day of December, 2003.

Ron Sims, County Executive

Attachments A. Exhibit "B" - Legal Description, B. Exhibit C-1 - Location Map, C. Exhibit C-2 -
Boundary Map

EXHIBIT "B"

LEGAL DESCRIPTION

Tracts "EP-1", "PB-4", "PB-5", "PB-6", "SA-7", "SA-8", "SA-9" and "SA-10", along with portions of Parcel "Z-3" and Tract "P-5", Trilogy at Redmond Ridge, according to the plat recorded in Volume 203 of Plats, pages 68 through 96, inclusive, under Recording No. 20011204001049, records of King County, Washington, being more particularly described as follows:

The southwest quarter of the northwest quarter and the northwest quarter of the southwest quarter of Section 22, Township 26 North, Range 6 East, W.M., in King County, Washington.

ALONG WITH that portion of the northeast quarter of the southwest quarter of Section 22, Township 26 North, Range 6 East, W.M., in King County, Washington, lying southwesterly of the southwest margin of a 100 foot wide strip of land conveyed to Siler Logging Company by deed recorded under Recording No. 1827216.

ALSO ALONG WITH a 100 foot wide strip of land as conveyed to Siler Logging Company by deed recorded under Recording No. 1827216, located in the northeast quarter of the southwest quarter of Section 22, Township 26 North, Range 6 East, W.M., in King County, Washington.

2003-0429

14810

ATTACHMENT B

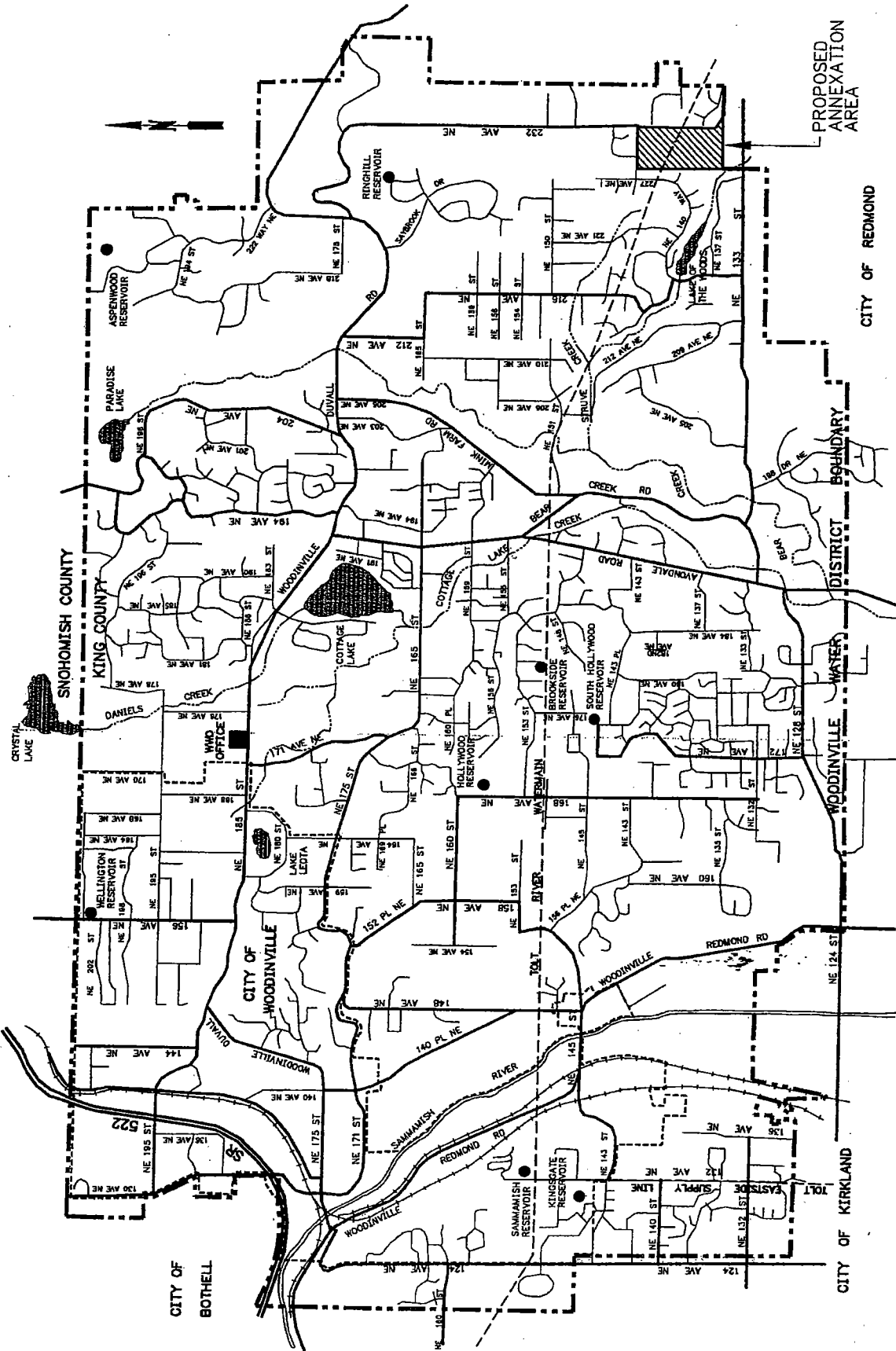

WOODINVILLE WATER DISTRICT

EXHIBIT C-1
LOCATION MAP

14810

ATTACHMENT C

2003-0429

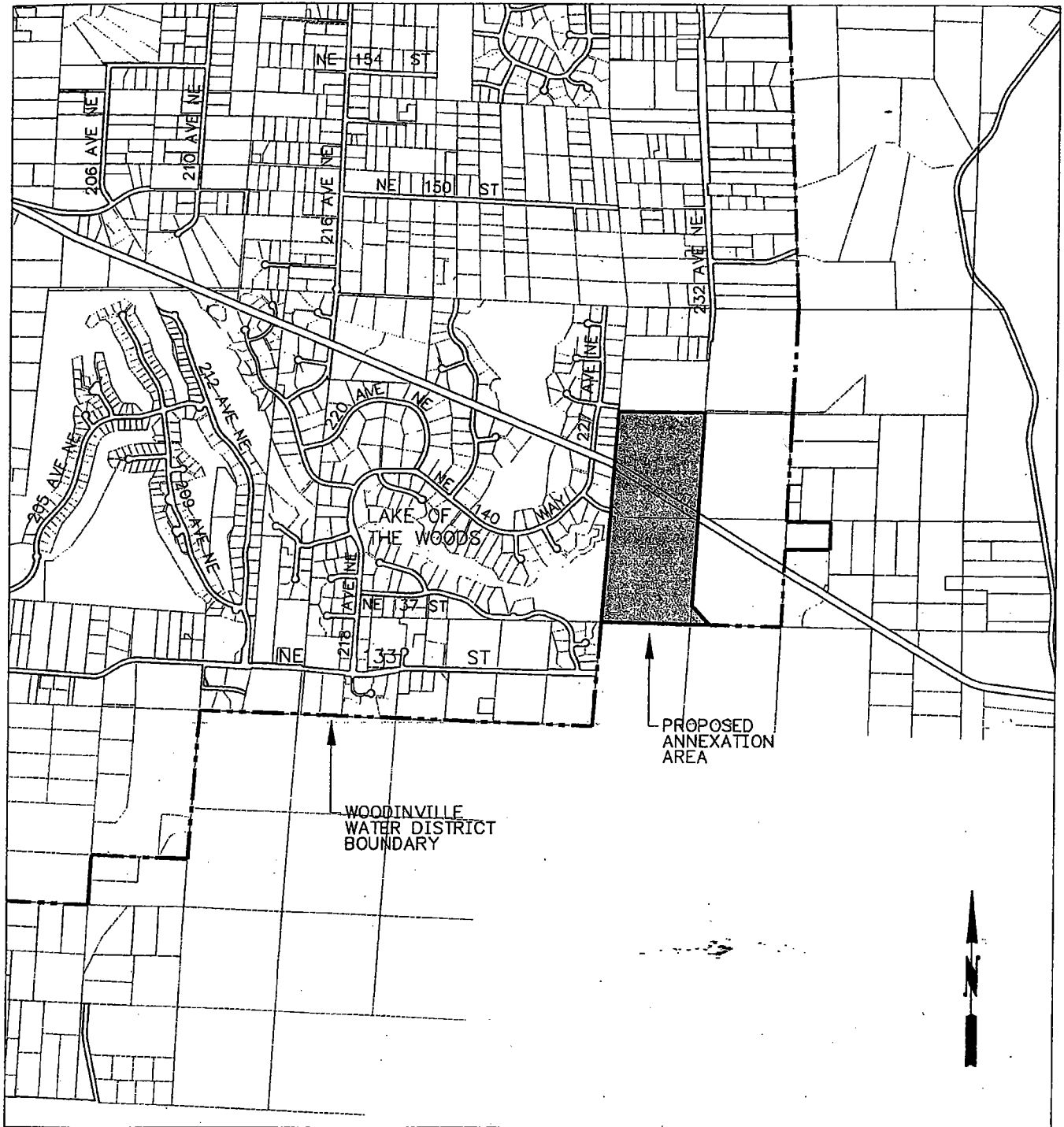

EXHIBIT C-2
BOUNDARY MAP



12507 BEL-RED ROAD SUITE 101
BELLEVUE, WA 98005-2500

CHS ENGINEERS INC.

TEL (425) 637-3693 FAX (425) 637-3694

Scale

NTS

Sheet

1 / 1

Drawn by JK

Approved by _____

Checked by _____

Date 10/02